



29 (TBI) Texas Bioscience Institute  
5701 Airport Rd. Temple, Tx

# TEMPLE COLLEGE

WEST CAMPUS BUILDING NUMBERS		Room #
1. Instructional Services Center (ISC)		101 - 181
2. Berry Hall (BBH)		202 - 208
3. Newton Science Building (NSB)		301 - 314
4. Hubert M. Dawson Library (HDL)		401 - 421
5. Watson Technical Center (WTC)		501 - 575
7. Mary Alice Marshall Performing Arts Center (PAC)		700 - 716
8. Arnold Student Center (ASC) (Bookstore and Food Court)		801 - 830
9. Marc A. Niglazzo Administration Building (ADM)		901 - 957
11. Math & Biomedical Science (MBS)		1100 - 1161
12. Maintenance Building (MNT)		
14. One College Centre (OCC)		1400 - 1476
16. Mail Room/Computer Storage		
17. Visual Arts Comp		
19. Cameron Education Center (CEC)		
20. Tramm Tennis Center (TTC)		
21. Downtown Center (DWT)		U100 - U211
27. Business Training Center (BTC)		
29. Texas		150
31. Writing		
32. TRIO Center		
33. Science Laboratory Building (SLB)		3301 - 3340
34. Academic Center (AC)		3401 - 3469
35. Carpenter Rehearsal Hall (CRH)		3526 - 3533

Bands Enter Here

Rear parking / buses

EAST CAMPUS BUILDING NUMBERS		Room #
6. Health and Physical Education Center (HPE)		600 - 616
10. Dell Martin Nursing Education Center (NEC)		1003 - 1090
13. EWCHEC-Taylor (EWHC) EWCHEC-Hutto (EHUT)		102 - 144
15. Golf Shop (GOLF)		1801 - 1899
18. Health Sciences Center (HSC)		
19. Cameron Education Center (CEC)		U100 - U211
21. Downtown Center (DWT)		
27. Business Training Center (BTC)		
23. Danny Scott Sports Complex (SSC)		2800 - 2802
28. Pavilion (PAV)		
50. Temple College Apartments (TCA)		
51. University Courtyard Apartments (UCA)		

**PARKING GUIDE**

- STUDENT PARKING
- OPEN PARKING
- STAFF PARKING
- VISITOR PARKING

From IH-35  
Turn here!

TO IH 35

19 (CEC) Hwy 36 To Cameron Education Center  
804 East First Street - Cameron, Tx

13 (EWHC) Hwy 95 To EWCHEC-Taylor  
516 North Main - Taylor, Tx

(EHUT) EWCHEC - HUTTO  
555 Linnier Loop - Round Rock, Tx

From HWY 36

Revised January 2013

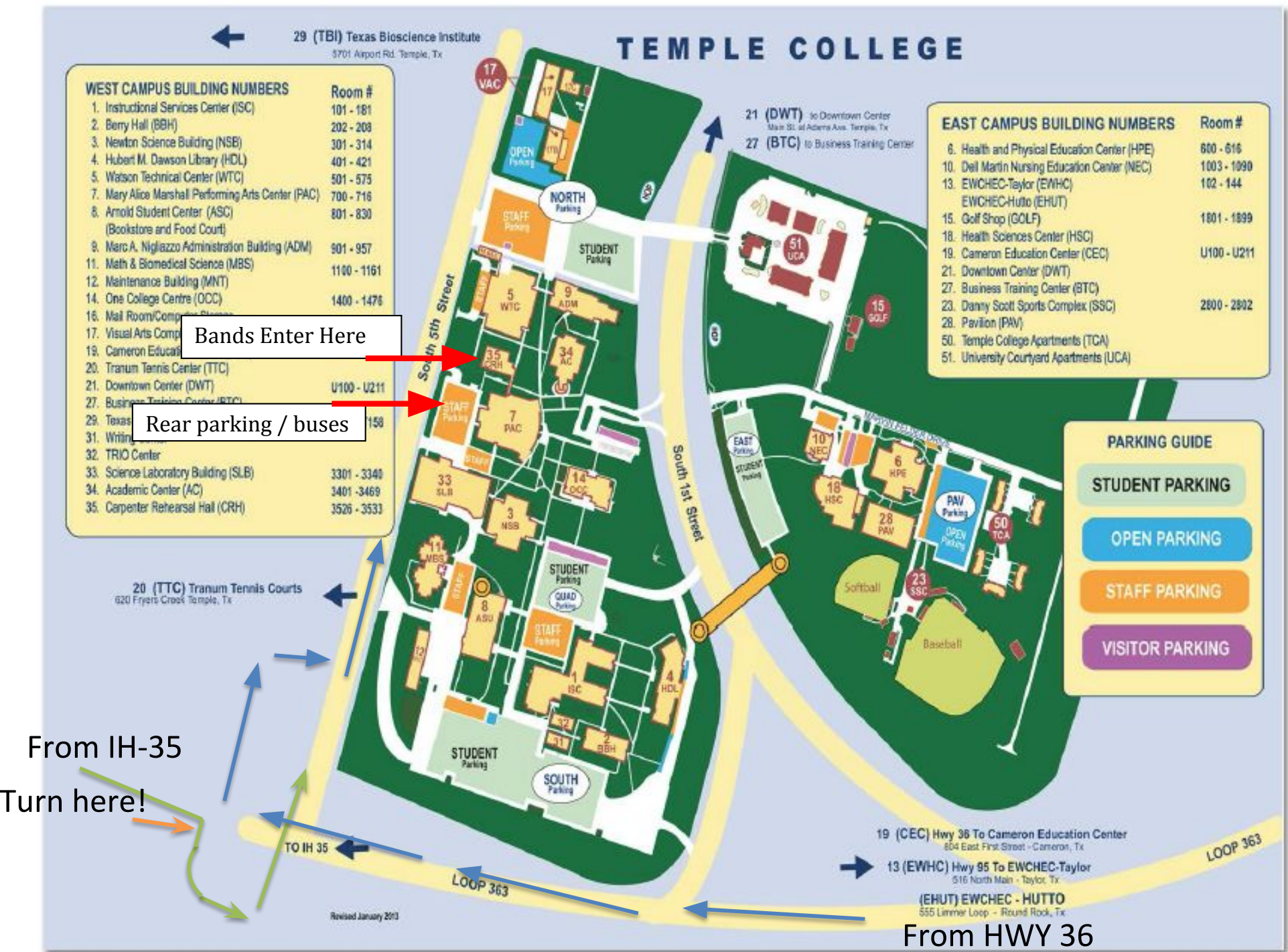

Directions to TC from IH-35

Take **Loop 363/Hwy36 Exit**.

Head **East** on **Loop 363/Hwy 36**

Take the exit for 5<sup>th</sup> St.; **get in the right hand lane**

Turn right to **get to 5<sup>th</sup> St.**

Turn **Left** on to **5<sup>th</sup> street**.

Go over the overpass.

Turn **right** into **the 2<sup>nd</sup> or 3rd entrance** (rear parking lot).

### **Directions to TC from HWY 36**

Heading WEST on Hwy 36

Go through the light at S. 1<sup>st</sup> street and keep in the right hand lane.

Go under the overpass and make an immediate right turn.

At the stop sign turn left onto S. 5<sup>th</sup> street.

The rear parking lot of the PAC will be on your right.

# Temple College Band Invitational

Loading dock

Warm-up Room

Carpenter  
Rehearsal Hall



Bands enter

Exit

To stage

REAR  
PARKING  
LOT

BUSES

2570 S. 5<sup>th</sup> St.

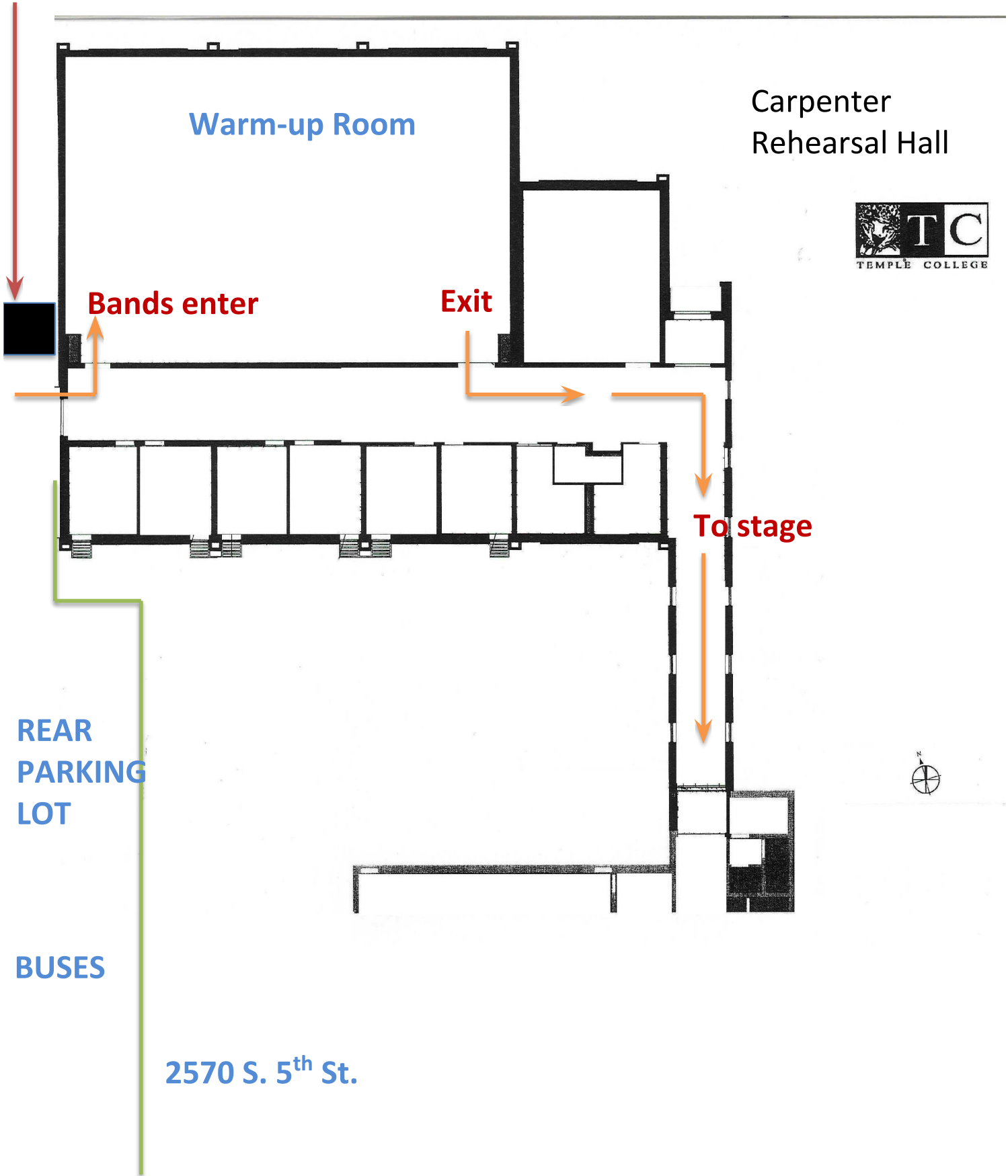

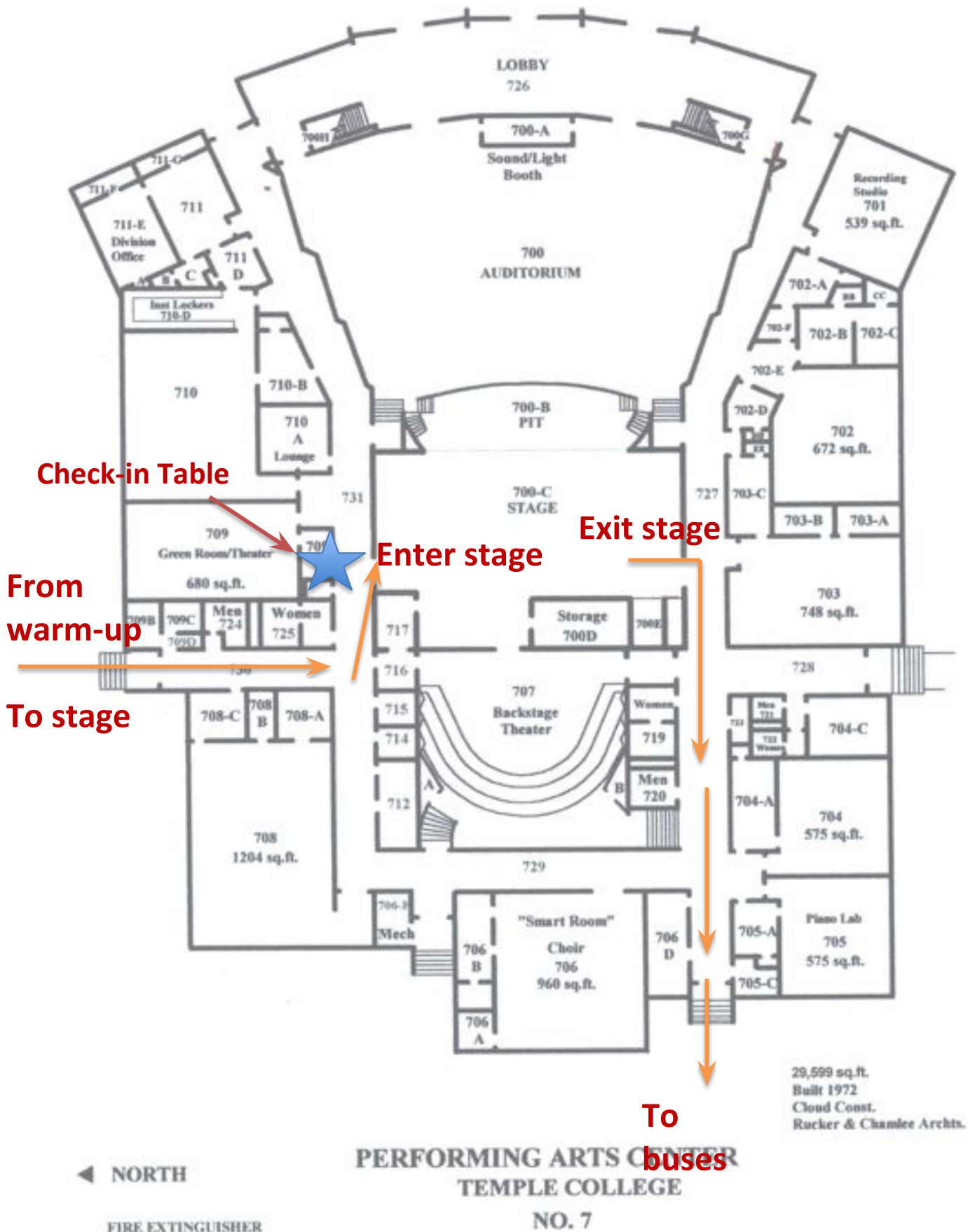

Rear parking lot - buses